

For use with aggressive media and in areas susceptible to corrosive outside influences, in the food processing industry and in hygienic and sanitary applications.

| | |
|-----------------------------------|---|
| Material | Stainless steel 1.4404 |
| Sealant | FPM |
| Pressure | max. 15 bar (depending on pipe quality) |
| Working pressure pulsate: | max. 10 bar |
| Medium and operating temperature: | -20 °C to max. 150 °C (depending on pipe quality and diameter) |
| Suitable pipe materials: | PVDF, PTFE, PA, PU |

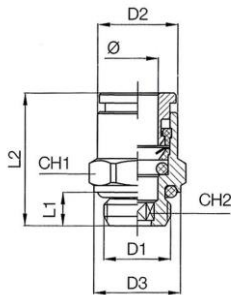

44.018-4 ES

Male connector, parallel male thread with O-ring (FPM) and outer hex

| Art. No. | Type No. | For tube O.D. mm | D1 mm | D2 mm | D3 mm | L1 mm | L2 mm | CH1 mm | CH2 mm | weight (g) |
|---|--------------|------------------|-------|-------|-------|-------|-------|--------|--------|------------|
| 110359 | 44.005-4 ES | 4 | M5 | 9.0 | 8.0 | 4.0 | 19.0 | 9 | - | 4.9 |
| Art. No. 110359 = discontinued product. No longer available. New product 135058 (844.005-4 ES) | | | | | | | | | | |
| 110360 | 44.018-4 ES | 4 | G 1/8 | 9.0 | 13.0 | 5.0 | 16.6 | 13 | 3 | 8.0 |
| Art. No. 110360 = discontinued product. No longer available. New product 135059 (844.018-4 ES) | | | | | | | | | | |
| 110361 | 44.018-6 ES | 6 | G 1/8 | 12.0 | 13.0 | 5.0 | 19.7 | 13 | 4 | 10.0 |
| Art. No. 110361 = discontinued product. No longer available. New product 135060 (844.018-6 ES) | | | | | | | | | | |
| 110362 | 44.018-8 ES | 8 | G 1/8 | 14.0 | 13.0 | 5.0 | 23.2 | 14 | 6 | 12.5 |
| Art. No. 110362 = discontinued product. No longer available. New product 135061 (844.018-8 ES) | | | | | | | | | | |
| 110363 | 44.014-6 ES | 6 | G 1/4 | 12.0 | 16.0 | 6.5 | 19.7 | 16 | 4 | 15.5 |
| Art. No. 110363 = discontinued product. No longer available. New product 135063 (844.014-6 ES) | | | | | | | | | | |
| 110364 | 44.014-8 ES | 8 | G 1/4 | 14.0 | 16.0 | 6.5 | 21.7 | 16 | 6 | 15.5 |
| Art. No. 110364 = discontinued product. No longer available. New product 135064 (844.014-8 ES) | | | | | | | | | | |
| 110365 | 44.014-10 ES | 10 | G 1/4 | 16.0 | 16.0 | 6.5 | 27.2 | 16 | 8 | 39.0 |
| Art. No. 110365 = discontinued product. No longer available. New product 135065 (844.014-10 ES) | | | | | | | | | | |
| 110366 | 44.038-10 ES | 10 | G 3/8 | 16.0 | 20.0 | 7.0 | 24.7 | 17 | 8 | 39.0 |
| Art. No. 110366 = discontinued product. No longer available. New product 135068 (844.038-10 ES) | | | | | | | | | | |
| 110367 | 44.038-12 ES | 12 | G 3/8 | 19.0 | 20.0 | 7.0 | 27.9 | 21 | 10 | 32.0 |
| Art. No. 110367 = discontinued product. No longer available. New product 135069 (844.038-12 ES) | | | | | | | | | | |
| 110368 | 44.012-12 ES | 12 | G 1/2 | 19.0 | 25.0 | 8.5 | 26.4 | 22 | 10 | 39.0 |
| Art. No. 110368 = discontinued product. No longer available. New product 135072 (844.012-12 ES) | | | | | | | | | | |

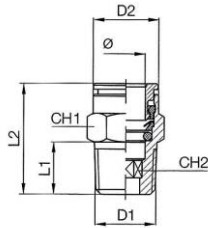

45.018-8 ES

Male connector, conical male thread with outer hex

| Art. No. | Type No. | For tube O.D. mm | D1 mm | D2 mm | L1 mm | L2 mm | CH1 mm | CH2 mm | weight (g) |
|---|--------------|------------------------|----------|----------|----------|----------|-----------|-----------|---------------|
| 110369 | 45.018-4 ES | 4 | R 1/8 | 9.0 | 7.0 | 16.6 | 10 | 3 | 6.0 |
| Art. No. 110369 = discontinued product. No longer available. New product 135075 (845.018-4 ES) | | | | | | | | | |
| 110370 | 45.018-6 ES | 6 | R 1/8 | 12.0 | 6.9 | 21.2 | 12 | 4 | 9.0 |
| Art. No. 110370 = discontinued product. No longer available. New product 135076 (845.018-6 ES) | | | | | | | | | |
| 110371 | 45.018-8 ES | 8 | R 1/8 | 14.0 | 6.8 | 25.2 | 14 | 6 | 13.5 |
| Art. No. 110371 = discontinued product. No longer available. New product 135077 (845.018-8 ES) | | | | | | | | | |
| 110372 | 45.014-4 ES | 4 | R 1/4 | 9.0 | 10.0 | 20.6 | 14 | 3 | 16.0 |
| Art. No. 110372 = discontinued product. No longer available. New product 135078 (845.014-4 ES) | | | | | | | | | |
| 110373 | 45.014-6 ES | 6 | R 1/4 | 12.0 | 11.0 | 20.7 | 14 | 4 | 14.0 |
| Art. No. 110373 = discontinued product. No longer available. New product 135079 (845.014-6 ES) | | | | | | | | | |
| 110374 | 45.014-8 ES | 8 | R 1/4 | 14.0 | 11.0 | 23.7 | 14 | 6 | 14.0 |
| Art. No. 110374 = discontinued product. No longer available. New product 135080 (845.014-8 ES) | | | | | | | | | |
| 110375 | 45.014-10 ES | 10 | R 1/4 | 16.0 | 11.0 | 30.3 | 16 | 8 | 20.0 |
| Art. No. 110375 = discontinued product. No longer available. New product 135081 (845.014-10 ES) | | | | | | | | | |
| 110376 | 45.038-10 ES | 10 | R 3/8 | 16.0 | 11.5 | 23.5 | 17 | 8 | 21.0 |
| Art. No. 110376 = discontinued product. No longer available. New product 135084 (845.038-10 ES) | | | | | | | | | |
| 110377 | 45.038-12 ES | 12 | R 3/8 | 18.0 | 11.5 | 27.4 | 19 | 10 | 26.0 |
| Art. No. 110377 = discontinued product. No longer available. New product 135085 (845.038-12 ES) | | | | | | | | | |
| 110378 | 45.012-12 ES | 12 | R 1/2 | 18.0 | 14.0 | 27.4 | 22 | 10 | 41.0 |

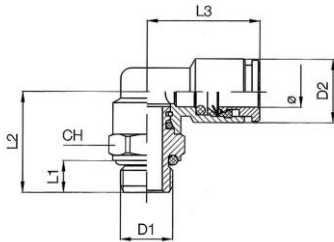

43.014-6 ES

Male elbow, swivel type, parallel male thread with O-ring (FPM)

| Art. No. | Type No. | For tube O.D. mm | D1 mm | D2 mm | L1 mm | L2 mm | L3 mm | CH mm | weight (g) |
|---|--------------|------------------------|----------|----------|----------|----------|----------|----------|---------------|
| 110379 | 43.005-4 ES | 4 | M5 | 9.0 | 4.0 | 14.8 | 17.0 | 9 | 8.7 |
| Art. No. 110379 = discontinued product. No longer available. New product 135123 (843.005-4 ES) | | | | | | | | | |
| 110380 | 43.018-4 ES | 4 | G 1/8 | 9.0 | 5.0 | 16.0 | 17.0 | 13 | 12.0 |
| Art. No. 110380 = discontinued product. No longer available. New product 135124 (843.018-4 ES) | | | | | | | | | |
| 110381 | 43.018-6 ES | 6 | G 1/8 | 12.0 | 5.0 | 18.0 | 21.5 | 13 | 20.0 |
| Art. No. 110381 = discontinued product. No longer available. New product 135125 (843.018-6 ES) | | | | | | | | | |
| 110382 | 43.018-8 ES | 8 | G 1/8 | 14.0 | 5.0 | 18.0 | 22.0 | 13 | 22.0 |
| Art. No. 110382 = discontinued product. No longer available. New product 135126 (843.018-8 ES) | | | | | | | | | |
| 110383 | 43.014-6 ES | 6 | G 1/4 | 12.0 | 6.5 | 20.0 | 21.5 | 16 | 24.0 |
| Art. No. 110383 = discontinued product. No longer available. New product 135128 (843.014-6 ES) | | | | | | | | | |
| 110384 | 43.014-8 ES | 8 | G 1/4 | 14.0 | 6.5 | 20.0 | 22.0 | 16 | 25.5 |
| Art. No. 110384 = discontinued product. No longer available. New product 135129 (843.014-8 ES) | | | | | | | | | |
| 110385 | 43.014-10 ES | 10 | G 1/4 | 16.0 | 6.5 | 22.5 | 25.5 | 16 | 35.0 |
| Art. No. 110385 = discontinued product. No longer available. New product 135130 (843.014-10 ES) | | | | | | | | | |
| 110386 | 43.038-10 ES | 10 | G 3/8 | 16.0 | 7.0 | 24.0 | 25.5 | 21 | 42.0 |
| Art. No. 110386 = discontinued product. No longer available. New product 135133 (843.038-10 ES) | | | | | | | | | |
| 110387 | 43.038-12 ES | 12 | G 3/8 | 19.0 | 7.0 | 26.5 | 28.0 | 21 | 60.0 |
| Art. No. 110387 = discontinued product. No longer available. New product 135134 (843.038-12 ES) | | | | | | | | | |
| 110388 | 43.012-12 ES | 12 | G 1/2 | 19.0 | 8.5 | 31.0 | 28.0 | 22 | 81.0 |
| Art. No. 110388 = discontinued product. No longer available. New product 135137 (843.012-12 ES) | | | | | | | | | |

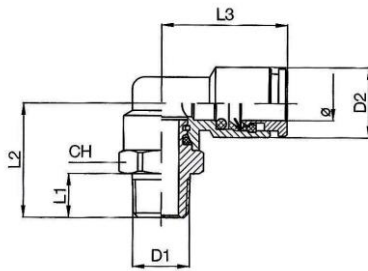

54.018-4 ES

Male elbow, swivel type, conical male thread

| Art. No. | Type No. | For tube O.D. mm | D1 mm | D2 mm | L1 mm | L2 mm | L3 mm | CH mm | weight (g) |
|---|--------------|------------------------|----------|----------|----------|----------|----------|----------|---------------|
| 110389 | 54.018-4 ES | 4 | R 1/8 | 9.0 | 7.5 | 17.5 | 17.0 | 10 | 11.0 |
| Art. No. 110389 = discontinued product. No longer available. New product 135140 (854.018-4 ES) | | | | | | | | | |
| 110390 | 54.018-6 ES | 6 | R 1/8 | 12.0 | 7.5 | 20.0 | 21.5 | 13 | 21.0 |
| Art. No. 110390 = discontinued product. No longer available. New product 135141 (854.018-6 ES) | | | | | | | | | |
| 110391 | 54.018-8 ES | 8 | R 1/8 | 14.0 | 7.5 | 20.0 | 22.0 | 13 | 22.5 |
| Art. No. 110391 = discontinued product. No longer available. New product 135142 (854.018-8 ES) | | | | | | | | | |
| 110392 | 54.014-6 ES | 6 | R 1/4 | 12.0 | 11.0 | 24.0 | 21.5 | 14 | 25.0 |
| Art. No. 110392 = discontinued product. No longer available. New product 135144 (854.014-6 ES) | | | | | | | | | |
| 110393 | 54.014-8 ES | 8 | R 1/4 | 14.0 | 11.0 | 24.0 | 22.0 | 14 | 26.5 |
| Art. No. 110393 = discontinued product. No longer available. New product 135145 (854.014-8 ES) | | | | | | | | | |
| 110394 | 54.014-10 ES | 10 | R 1/4 | 16.0 | 11.0 | 26.5 | 25.5 | 16 | 37.0 |
| Art. No. 110394 = discontinued product. No longer available. New product 135146 (854.014-10 ES) | | | | | | | | | |
| 110395 | 54.038-10 ES | 10 | R 3/8 | 16.0 | 11.5 | 27.0 | 25.5 | 17 | 40.0 |
| Art. No. 110395 = discontinued product. No longer available. New product 135149 (854.038-10 ES) | | | | | | | | | |
| 110396 | 54.038-12 ES | 12 | R 3/8 | 18.0 | 11.5 | 30.5 | 28.0 | 22 | 61.5 |
| Art. No. 110396 = discontinued product. No longer available. New product 135150 (854.038-12 ES) | | | | | | | | | |
| 110397 | 54.012-12 ES | 12 | R 1/2 | 18.0 | 14.0 | 33.5 | 28.0 | 22 | 66.0 |
| Art. No. 110397 = discontinued product. No longer available. New product 135153 (854.012-12 ES) | | | | | | | | | |

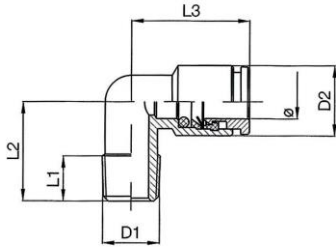

52.014-6 ES

Male elbow conical male thread

| Art. No. | Type No. | For tube O.D. mm | D1 mm | D2 mm | L1 mm | L2 mm | L3 | weight (g) |
|--|--------------|---------------------|----------|----------|----------|----------|------|---------------|
| 110398 | 52.018-4 ES | 4 | R 1/8 | 9.0 | 7.5 | 16.0 | 17.0 | 10.5 |
| Art. No. 110398 = discontinued product. No longer available. New product 135156 (852.018-4 ES) | | | | | | | | |
| 110399 | 52.018-6 ES | 6 | R 1/8 | 12.0 | 7.5 | 16.0 | 20.0 | 14.0 |
| Art. No. 110399 = discontinued product. No longer available. New product 135157 (852.018-6 ES) | | | | | | | | |
| 110400 | 52.018-8 ES | 8 | R 1/8 | 14.0 | 7.5 | 17.0 | 21.0 | 19.0 |
| 110401 | 52.014-6 ES | 6 | R 1/4 | 12.0 | 11.0 | 20.0 | 20.0 | 21.0 |
| Art. No. 110401 = discontinued product. No longer available. New product 135160 (852.014-6 ES) | | | | | | | | |
| 110402 | 52.014-8 ES | 8 | R 1/4 | 14.0 | 11.0 | 20.0 | 21.0 | 22.0 |
| 110403 | 52.014-10 ES | 10 | R 1/4 | 16.0 | 11.0 | 22.5 | 25.5 | 39.5 |

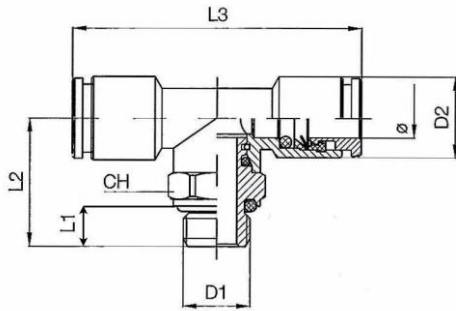

55.014-8 ES

Male branch tee, swivel type, parallel male thread with O-ring (FPM)

| Art. No. | Type No. | For tube O.D. mm | D1 mm | D2 mm | L1 mm | L2 mm | L3 mm | CH mm | weight (g) |
|--|--------------|------------------|-------|-------|-------|-------|-------|-------|------------|
| 110404 | 55.005-4 ES | 4 | M5 | 9.0 | 4.0 | 18.0 | 34.0 | 9 | 14.0 |
| Art. No. 110404 = discontinued product. No longer available. New product 135172 (855.005-4 ES) | | | | | | | | | |
| 110405 | 55.018-4 ES | 4 | G 1/8 | 9.0 | 5.0 | 20.0 | 34.0 | 13 | 17.0 |
| 110406 | 55.018-6 ES | 6 | G 1/8 | 12.0 | 5.0 | 22.5 | 42.0 | 13 | 29.0 |
| 110407 | 55.018-8 ES | 8 | G 1/8 | 14.0 | 5.0 | 22.5 | 43.0 | 13 | 30.5 |
| 110408 | 55.014-6 ES | 6 | G 1/4 | 12.0 | 6.5 | 24.5 | 42.0 | 16 | 33.0 |
| Art. No. 110408 = discontinued product. No longer available. New product 135177 (855.014-6 ES) | | | | | | | | | |
| 110409 | 55.014-8 ES | 8 | G 1/4 | 14.0 | 6.5 | 24.5 | 43.0 | 16 | 34.5 |
| 110410 | 55.014-10 ES | 10 | G 1/4 | 16.0 | 6.5 | 25.5 | 50.0 | 16 | 57.0 |
| 110411 | 55.038-10 ES | 10 | G 3/8 | 16.0 | 7.0 | 27.0 | 50.0 | 21 | 64.0 |

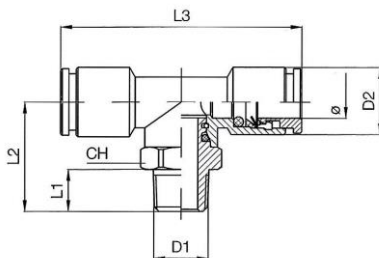

755.014-6 ES

Male branch tee, swivel type, conical male thread

| Art. No. | Type No. | For tube O.D. mm | D1 mm | D2 mm | L1 mm | L2 mm | L3 mm | CH mm | weight (g) |
|--|---------------|------------------|-------|-------|-------|-------|-------|-------|------------|
| 110412 | 755.018-4 ES | 4 | R 1/8 | 9.0 | 7.5 | 21.5 | 34.0 | 10 | 15.5 |
| Art. No. 110412 = discontinued product. No longer available. New product 135189 (8755.018-4 ES) | | | | | | | | | |
| 110413 | 755.018-6 ES | 6 | R 1/8 | 12.0 | 7.5 | 24.5 | 42.0 | 13 | 30.0 |
| 110414 | 755.018-8 ES | 8 | R 1/8 | 14.0 | 7.5 | 24.5 | 43.0 | 13 | 31.5 |
| 110415 | 755.014-6 ES | 6 | R 1/4 | 12.0 | 11.0 | 28.5 | 42.0 | 14 | 34.0 |
| 110416 | 755.014-8 ES | 8 | R 1/4 | 14.0 | 11.0 | 28.5 | 43.0 | 14 | 35.5 |
| 110417 | 755.014-10 ES | 10 | R 1/4 | 16.0 | 11.0 | 32.0 | 50.0 | 16 | 58.5 |
| 110418 | 755.038-10 ES | 10 | R 3/8 | 16.0 | 11.5 | 32.5 | 50.0 | 17 | 61.5 |
| Art. No. 110418 = discontinued product. No longer available. New product 135198 (8755.038-10 ES) | | | | | | | | | |

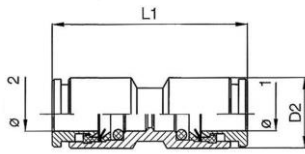

47.010 ES

Union

| Art. No. | Type No. | For tube O.D. 1 mm | For tube O.D. 2 mm | D2 mm | L1 mm | weight (g) |
|--|-----------|--------------------|--------------------|-------|-------|------------|
| 110419 | 47.004 ES | 4 | 4 | 9.0 | 28.2 | 7.5 |
| Art. No. 110419 = discontinued product. No longer available. New product 135242 (847.004 ES) | | | | | | |
| 110420 | 47.006 ES | 6 | 6 | 12.0 | 34.0 | 16.0 |
| Art. No. 110420 = discontinued product. No longer available. New product 135243 (847.006 ES) | | | | | | |
| 110421 | 47.008 ES | 8 | 8 | 14.0 | 34.5 | 19.5 |
| Art. No. 110421 = discontinued product. No longer available. New product 135244 (847.008 ES) | | | | | | |
| 110422 | 47.010 ES | 10 | 10 | 16.0 | 38.2 | 24.5 |
| Art. No. 110422 = discontinued product. No longer available. New product 135245 (847.010 ES) | | | | | | |
| 110423 | 47.012 ES | 12 | 12 | 16.0 | 40.8 | 30.0 |
| Art. No. 110423 = discontinued product. No longer available. New product 135246 (847.012 ES) | | | | | | |

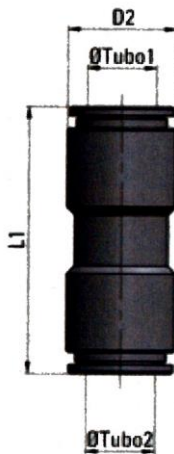

47.0806 ES

Reducer

| Art. No. | Type No. | For tube O.D. 1 mm | For tube O.D. 2 mm | D2 mm | L1 mm | weight (g) |
|---|------------|--------------------|--------------------|-------|-------|------------|
| 110424 | 47.0604 ES | 6 | 4 | 12.0 | 31.0 | 15.5 |
| Art. No. 110424 = discontinued product. No longer available. New product 135249 (847.0604 ES) | | | | | | |
| 110425 | 47.0806 ES | 8 | 6 | 14.0 | 34.0 | 22.3 |
| Art. No. 110425 = discontinued product. No longer available. New product 135250 (847.0806 ES) | | | | | | |

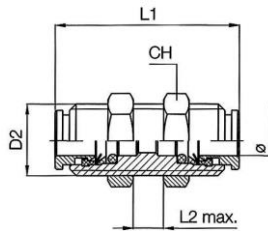

51.014-6 ES

Female bulkhead connector

| Art. No. | Type No. | For tube O.D. mm | D2 mm | L1 mm | L2 _{max.} mm | CH mm | weight (g) |
|---|--------------|------------------|---------|-------|-----------------------|-------|------------|
| 110426 | 51.012-4 ES | 4 | M12x1.0 | 28.0 | 11.0 | 15 | 24.0 |
| Art. No. 110426= discontinued product. No longer available. New product 135255 (851.011-4 ES) | | | | | | | |
| 110427 | 51.014-6 ES | 6 | M14x1.0 | 34.4 | 16.0 | 17 | 31.5 |
| Art. No. 110427 = discontinued product. No longer available. New product 135256 (851.014-6 ES) | | | | | | | |
| 110428 | 51.016-8 ES | 8 | M16x1.0 | 34.5 | 17.0 | 19 | 38.0 |
| Art. No. 110428 = discontinued product. No longer available. New product 135257 (851.016-8 ES) | | | | | | | |
| 110429 | 51.018-10 ES | 10 | M18x1.0 | 38.6 | 19.0 | 21 | 51.0 |
| Art. No. 110429 = discontinued product. No longer available. New product 135258 (851.018-10 ES) | | | | | | | |
| 110430 | 51.020-12 ES | 12 | M20x1.0 | 40.8 | 20.0 | 24 | 59.5 |

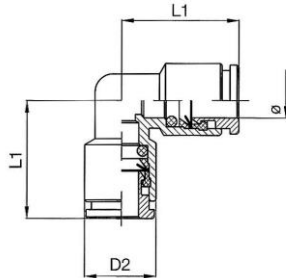

48.006 ES

Union elbow

| Art. No. | Type No. | For tube O.D. mm | D2 mm | L1 mm | weight (g) |
|--|-----------|------------------|-------|-------|------------|
| 110431 | 48.004 ES | 4 | 9.0 | 17.0 | 11.5 |
| Art. No. 110431 = discontinued product. No longer available. New product 135262 (848.004 ES) | | | | | |
| 110432 | 48.006 ES | 6 | 12.0 | 20.0 | 18.0 |
| Art. No. 110432 = discontinued product. No longer available. New product 135263 (848.006 ES) | | | | | |
| 110433 | 48.008 ES | 8 | 14.0 | 21.0 | 23.5 |
| 110434 | 48.010 ES | 10 | 16.0 | 25.0 | 41.0 |
| Art. No. 110434 = discontinued product. No longer available. New product 135265 (848.010 ES) | | | | | |
| 110435 | 48.012 ES | 12 | 18.0 | 27.0 | 44.0 |
| Art. No. 110435 = discontinued product. No longer available. New product 135266 (848.012 ES) | | | | | |

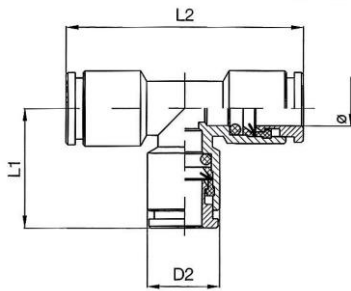

49.006 ES

Union tee

| Art. No. | Type No. | For tube O.D. mm | D2 mm | L1 mm | L2 mm | weight (g) |
|--|-----------|------------------|-------|-------|-------|------------|
| 110436 | 49.004 ES | 4 | 9.0 | 17.0 | 35.0 | 14.0 |
| 110437 | 49.006 ES | 6 | 12.0 | 20.0 | 42.0 | 29.5 |
| Art. No. 110437 = discontinued product. No longer available. New product 135270 (848.006 ES) | | | | | | |
| 110438 | 49.008 ES | 8 | 14.0 | 21.0 | 43.5 | 31.0 |
| 110439 | 49.010 ES | 10 | 16.0 | 25.0 | 50.0 | 55.0 |
| 110440 | 49.012 ES | 12 | 18.0 | 27.0 | 54.0 | 58.5 |

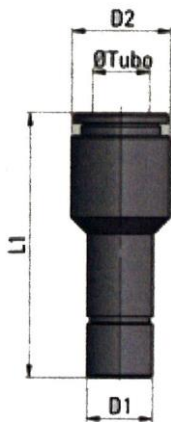

59.0806 ES

Reducer with push-in plug

| Art. No. | Type No. | For tube O.D. mm | D1 mm | D2 mm | L1 mm | weight (g) |
|----------|------------|------------------|-------|-------|-------|------------|
| 110441 | 59.0604 ES | 4 | 6 | 9 | 31.0 | 6.5 |
| 110442 | 59.0806 ES | 6 | 8 | 12 | 31.7 | 11.9 |
| 110443 | 59.1008 ES | 8 | 10 | 14 | 34.5 | 14.8 |

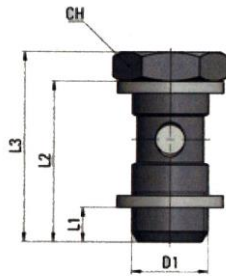

60.018 ES

Banjo bolt with PTFE seal, single

| Art. No. | Type No. | D1 mm | L1 mm | L2 mm | L3 mm | CH mm | weight (g) |
|----------|-----------|-------|-------|-------|-------|-------|------------|
| 110444 | 60.018 ES | G 1/8 | 6.0 | 25.0 | 29.0 | 14 | 15.1 |
| 110445 | 60.014 ES | G 1/4 | 6.5 | 27.5 | 32.5 | 17 | 26.1 |
| 110446 | 60.038 ES | G 3/8 | 7.0 | 30.0 | 36.0 | 21 | 44.2 |
| 110447 | 60.012 ES | G 1/2 | 8.5 | 35.5 | 41.5 | 26 | 80.0 |

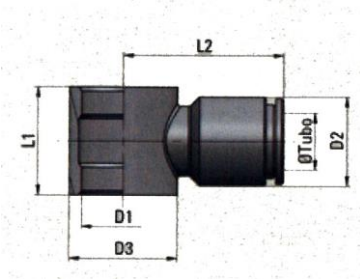

61.018-4 ES

Ring nipple, single

| Art. No. | Type No. | For tube O.D. mm | D1 mm | D2 mm | D3 mm | L1 mm | L2 mm | weight (g) |
|----------|--------------|------------------|-------|-------|-------|-------|-------|------------|
| 110448 | 61.018-4 ES | 4 | G 1/8 | 9.0 | 14.0 | 15.0 | 20.5 | 13.1 |
| 110449 | 61.018-6 ES | 6 | G 1/8 | 12.0 | 14.0 | 15.0 | 22.0 | 16.0 |
| 110450 | 61.018-8 ES | 8 | G 1/8 | 14.0 | 14.0 | 15.0 | 22.5 | 18.7 |
| 110451 | 61.014-6 ES | 6 | G 1/4 | 12.0 | 17.2 | 17.2 | 23.5 | 16.6 |
| 110452 | 61.014-8 ES | 8 | G 1/4 | 14.0 | 17.0 | 17.0 | 24.5 | 20.4 |
| 110453 | 61.014-10 ES | 10 | G 1/4 | 16.0 | 17.2 | 17.2 | 26.0 | 23.0 |
| 110454 | 61.038-10 ES | 10 | G 3/8 | 16.0 | 22.0 | 20.0 | 29.0 | 35.4 |
| 110455 | 61.038-12 ES | 12 | G 3/8 | 19.0 | 22.0 | 20.0 | 31.0 | 41.7 |
| 110456 | 61.012-12 ES | 12 | G 1/2 | 19.0 | 26.0 | 24.0 | 33.0 | 53.4 |

Assembling instructions for push-in fittings

- Cut the hose ends plain. To ensure an ideal sealing effect and secure stop of the fitting make sure the hose end is not oval.
- Clean the hose ends and make sure that it is free of burrs.
- Push the hose ends into the fitting till it stops.
- Test stability by pulling the hose shortly.
- Push the release ring to release the hose.
- Pull out the hose with slight rotation.
- For a new assembling cut the hose plain again. Then pushing and releasing the tube should not be affected adversely.